

EZ Carrier Electric

with Swing Away Attachment

Owner's Manual

Keep instructions for future reference

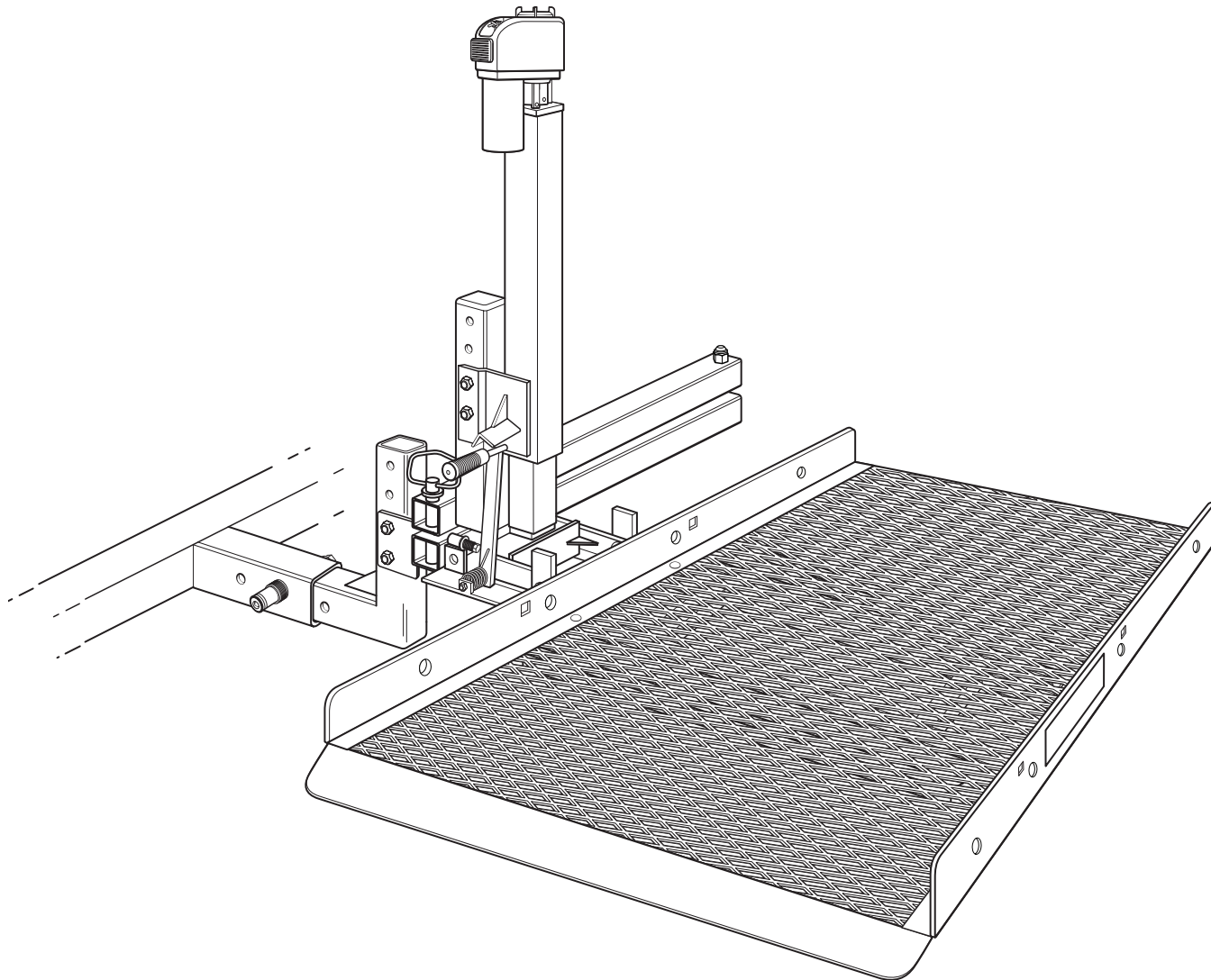

EZ CARRIER™ 
Your Key to Freedom™

Safety

- Failure to properly tighten bolts and insert pins where required may cause assembly failure, serious injury or death. Always check that all bolts are securely fastened and pins are locked in place before use of the product.
- A carrier and cargo add weight to the vehicle and improperly or under inflated tires may cause unexpected movement, serious injury or death. Always check the vehicle tires are properly inflated before using the carrier.
- A carrier and cargo add weight to the vehicle and lengthens the time and distance that it takes to merge with or pass other vehicles as well as stopping your vehicle. Failure to allow additional time and distance for these actions may result in an accident, serious injury or death. Review the guidelines provided by your automobile manufacturer's manual and adjust your riding accordingly, allowing extra time and distance for these actions.
- Vehicles parked on an incline or too close to curbs, steps and uneven surfaces may cause unexpected movement of the load or load tip over resulting in physical damage, serious injury or death. Always park the vehicle on a flat surface and engage the parking brake before placing a load on the carrier and moving the platform. Check the area around the platform is clear of the curb, flat and free of debris. Never stand between the vehicle and the platform.
- Positioning any part of your body close to the moving platform when loading and unloading may cause serious injury or death. Always maintain a safe distance away from the moving platform and all body parts. Never lie or reach underneath the platform without adequately blocking the space between the platform and ground.
- Use of the carrier for purposes other than the stated intent may cause physical damage, serious injury or death. Never allow children to climb, play or ride on the carrier. Do not place animals or unstable loads on the carrier. Do not overload the carrier, maximum weight capacity is 350 lb.
- When manually raising or lowering the platform the crank handle may unexpectedly spin when released causing serious injury or death. Always unplug the wiring and maintain control of the emergency crank handle and keep body parts (head, eyes etc.) away from the handle. Never push the rocker switch to the ON position when using the crank handle.
- Movement of the lift assembly and platform may create pinch points that could cause serious injury or death. Always keep all body parts, long hair, loose clothing and jewelry away from moving parts when using the carrier.
- Changing or adding unauthorized parts to the carrier and removing parts from the carrier may adversely affect the functionality of the product. These actions are not recommended and will void the warranty.

Parts

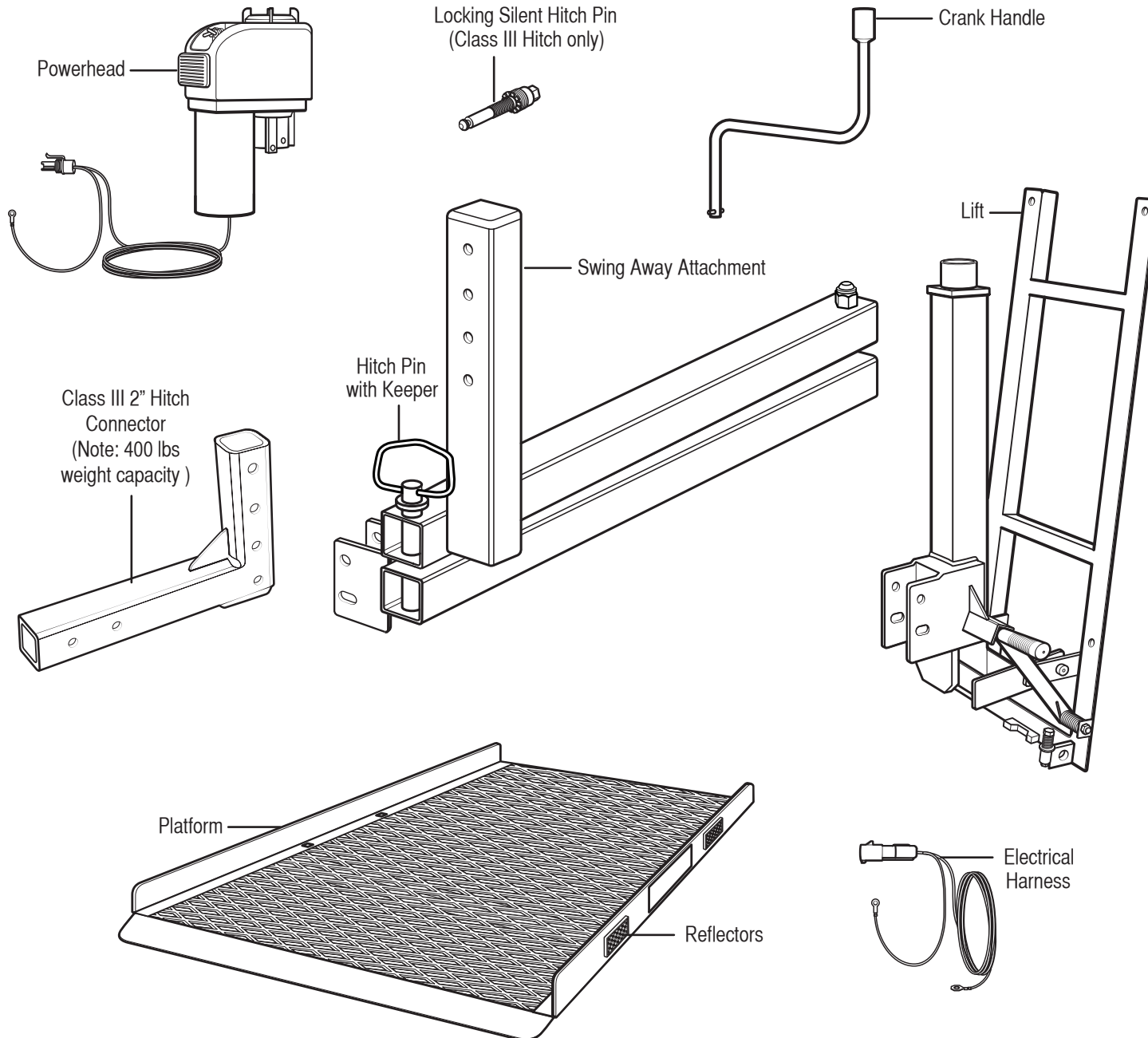

Hardware

- 1/2" x 1-1/2" Hex Bolt
- 1/2" Nut
- 1/2" x 4" Hex Bolt (x2)
- 1/2" Washer (x4)
- 1/2" All Steel Locking Nut (x4)
- 3/8" x 1 Carriage Bolt (x4)
- 3/8" Washer (x4)
- 3/8" All Steel Locking Nuts (x4)
- 7/16 x 1" Carriage Bolts (x2)
- 5/8" Washers (x2)
- 7/16" Nylock Nuts (x2)

Tools Required

- Wrench
- Ratchet
- Socket Wrench
- 5/32 Allen Hex Wrench
- Phillips Screwdriver
- Tape Measure
- Drill Motor

Assembly

Attaching the Hitch Connector

⚠ WARNING!

Failure to properly tighten bolts and insert pins where required may cause assembly failure, serious injury or death. Always check that all bolts are securely fastened and pins are locked in place before use of the product.

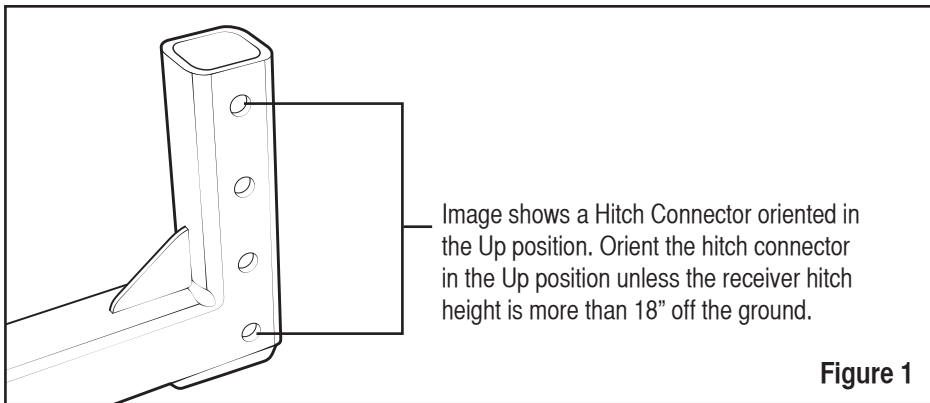

1. Insert the Spring Nut into the shank tube of the Hitch Connector (**Figure 2**). Align the spring and threads on the spring nut with the shank tube holes (**Note:** Use the hole that keeps the carrier as close to the vehicle as possible without touching the bumper when folded up into storage position.).
2. Slide the Hitch Connector into the Receiver hitch on the vehicle and align the holes between the two.
3. Insert the 5/8 x 1 3/4 bolt and lock washer into the Spring Nut and screw tight (**Figure 3**). The bolt should be tightened between 30 and 60 ft-lb of torque (e.g., similar to tightening a lug nut on a car wheel).

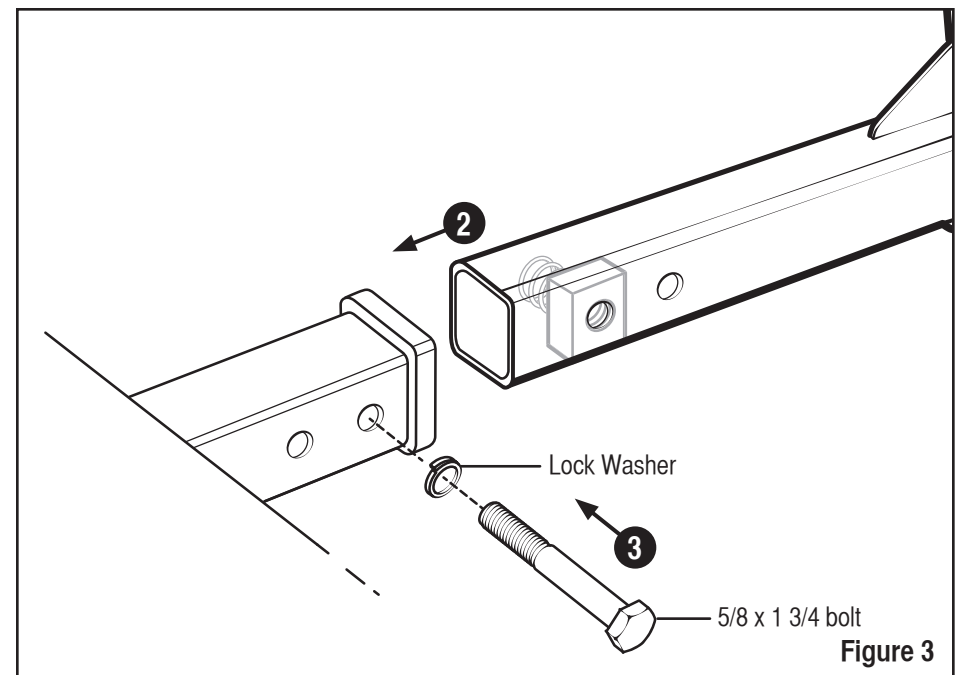
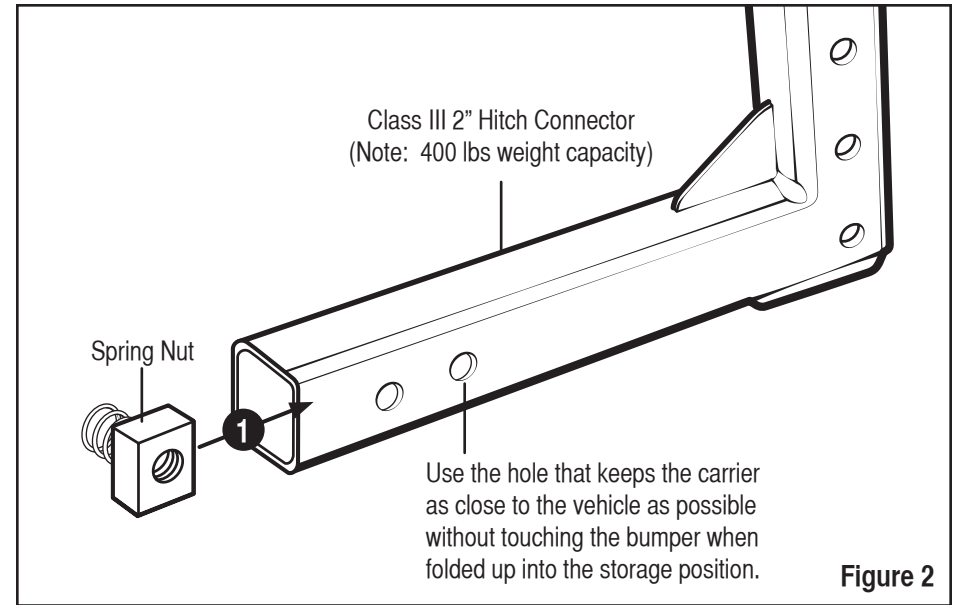

Attaching the Swing-Away Arm to the Hitch Connector

Note: The Swing-Away Arm is an optional part. Proceed to Attaching the Ramp Bracket if you do not have this option. Follow these steps if you are connecting the optional Swing-Away Arm to the Hitch Connector:

1. Place the Swing-Away Arm over the Hitch Connector and align the mounting holes (**Figure 4**).
2. Insert the 1/2 x 3-1/2 top bolt and place the nut on it.
3. Place a washer on the 1/2 x 3-1/2 bottom bolt and insert the bolt through the mounting holes.
4. Place a washer and nut on the bolt and finger tighten.
5. Adjust the tilt of the swing away so the swing away arm opens level to the ground.
6. Tighten the nuts for both bolts from 30 to 60 ft. lbs.

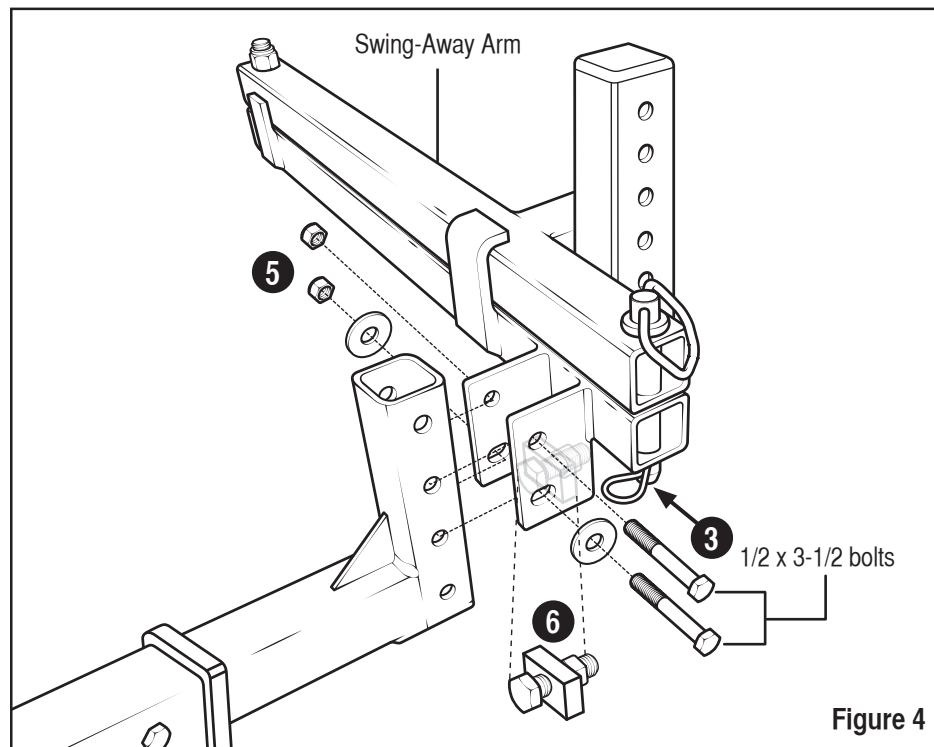

Figure 4

Attaching the Lift Assembly

Important! The Lift has 18" or 24" of travel. Position the Lift Assembly as high as possible, typically the distance from the ground to the upper bolt is as follows: 18" Actuator: 24 to 26 inches or 24" Actuator: 30 to 32 inches.

1. Align the holes in the Lift Assembly with the holes in the Swing Away Attachment (**Figure 5**).
2. Insert the 1/2" x 4" bolt into the upper holes. Attach the nut but do not tighten at this point (**Figure 6**).
3. Adjust the tilt of the Lift Assembly by turning the adjustment bolt until you have the desired angle (Note: It is recommended the top of the Actuator tilts slightly towards the vehicle). Tighten the nut on the adjusting bolt to secure the setting of the actuator.
4. Insert the second 1/2 x 4" bolt with the washers and nut into the lower, slotted holes.
5. Using a 3/4" hex tool, firmly tighten the nuts on the 1/2 x 4" bolts.

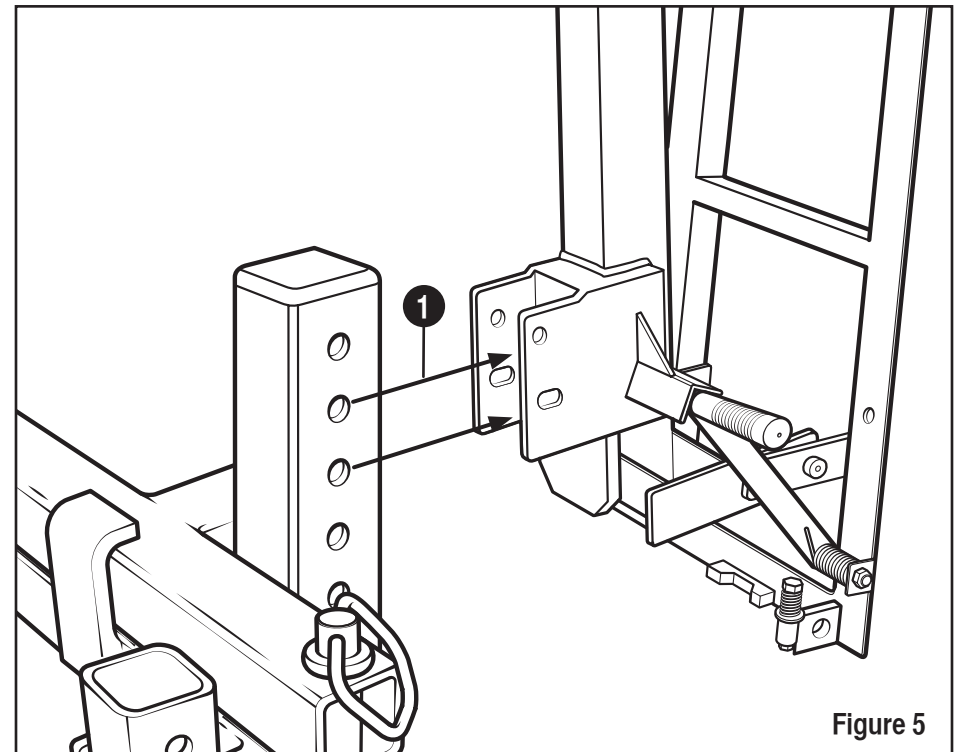

Figure 5

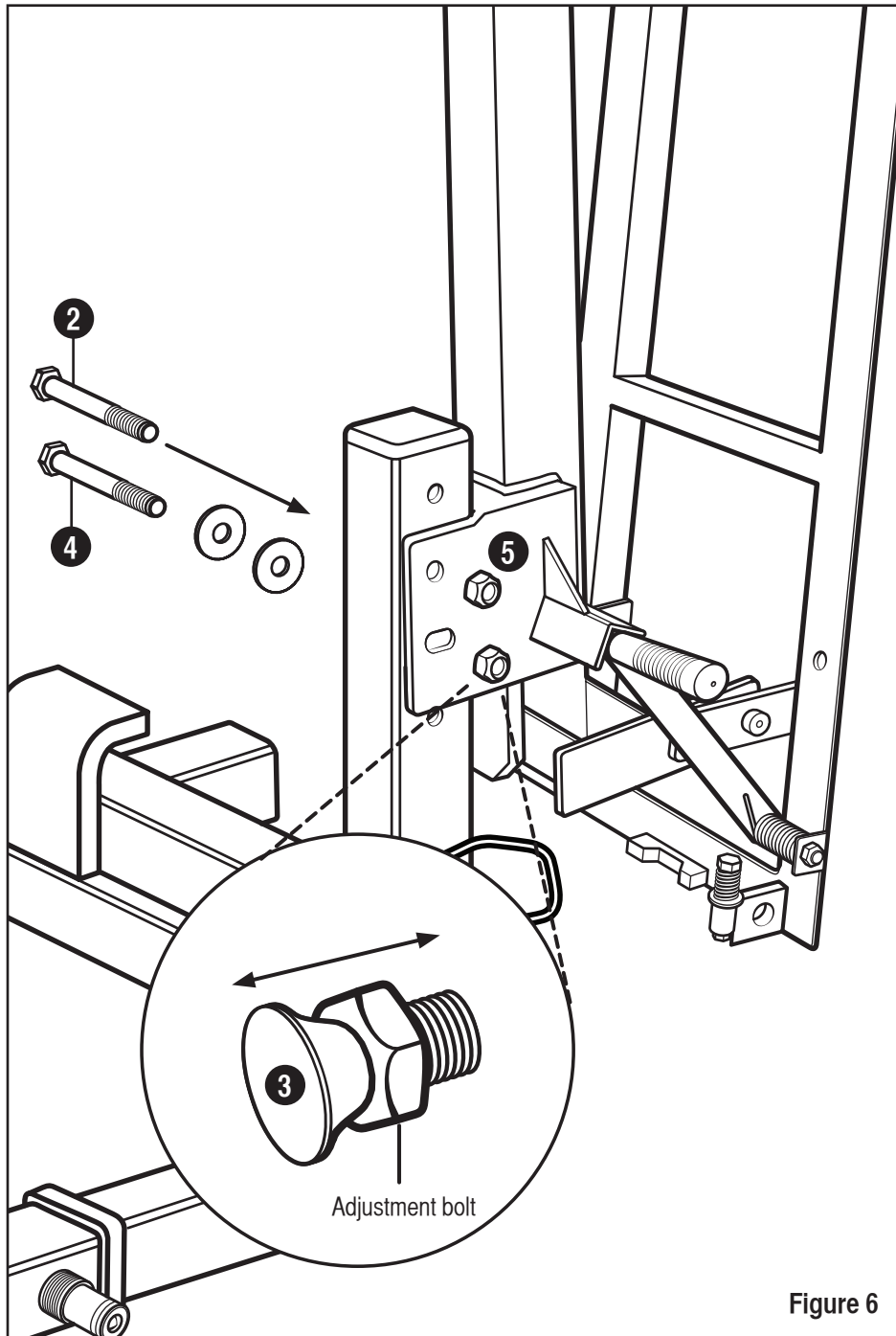

Figure 6

Attaching the Platform

1. Insert the crank into the top of the lift (**Figure 7**).
2. Rotate the crank counterclockwise to lower the lift.
3. Place the Platform on top of the Lift Assembly frame so the EZ Carrier stickers faces away from the vehicle.
4. Align the four square holes in the Platform with the holes in the Lift Assembly frame (**Figure 8**).

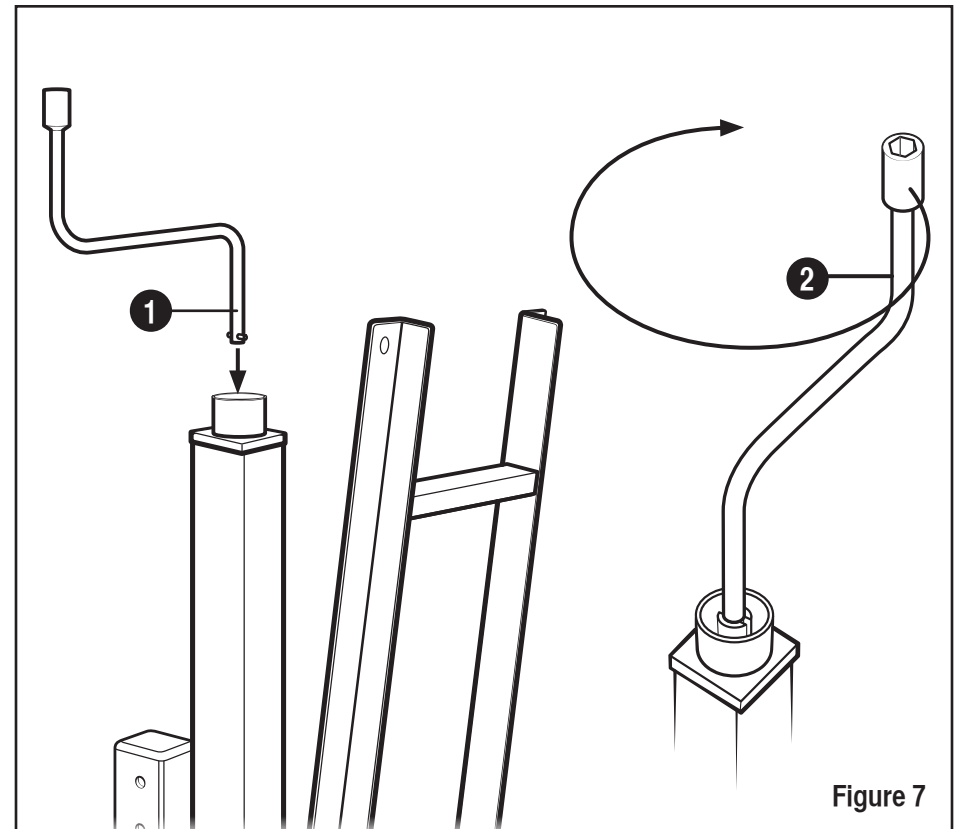

Figure 7

5. Insert each of the 3/8 x 1" square neck carriage bolts through the square holes in the platform.
6. From underneath the Lift Assembly frame, place the washers and nuts onto the bolts.
7. Using a 9/16 hex tool, firmly tighten the nuts.
8. Attach the included safety reflectors to the platform.

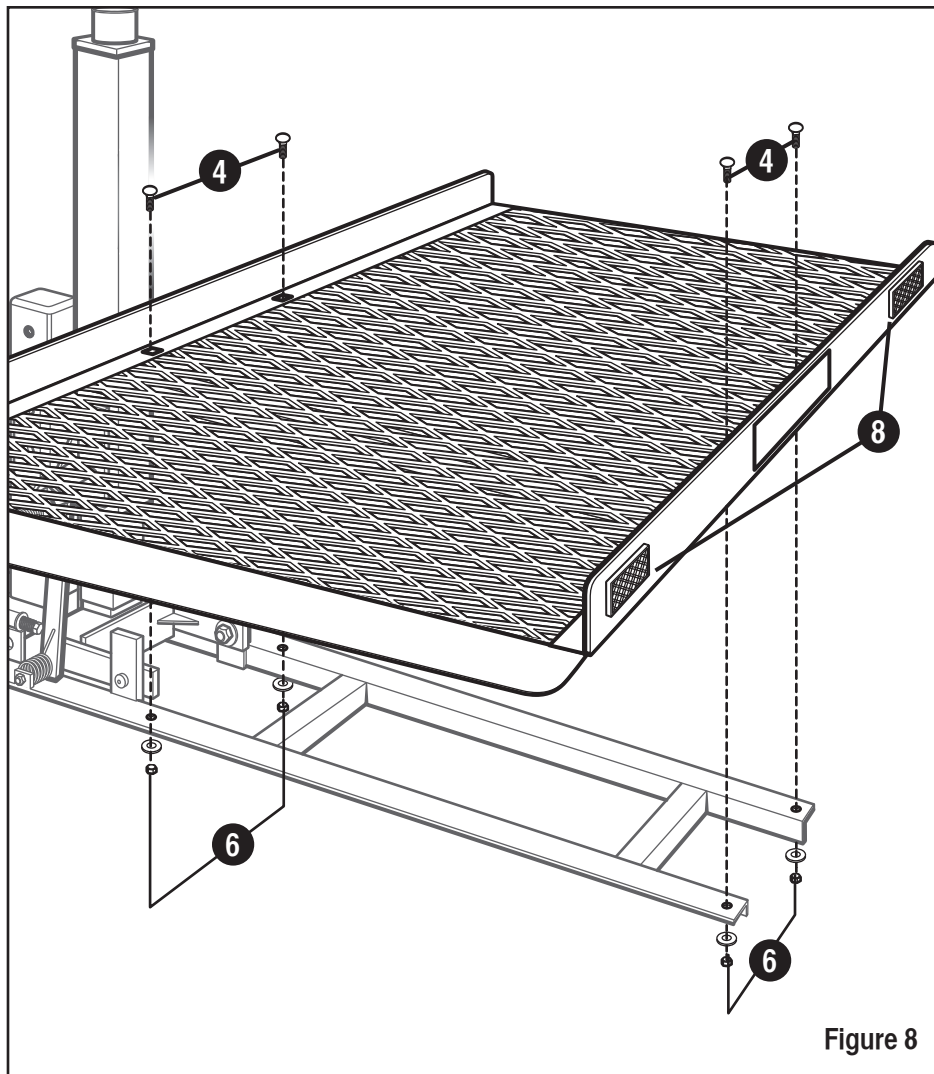

Figure 8

Attaching the Powerhead

Note: The Powerhead should be positioned so the controls are on drivers side of the Lift Assembly.

1. Manually rotate the slot in the top of the Lift Actuator so it lines up with the pin in the bottom of the Powerhead.
2. Set the Powerhead on the Lift Assembly (**Figure 9**).
3. Using a 5/32" Allen wrench, tighten the three threaded locking screws at the base of the Powerhead (**Figure 10**).
4. Connect the ground wire from the Powerhead's plug to the ground screw on the Actuator mounting bracket..

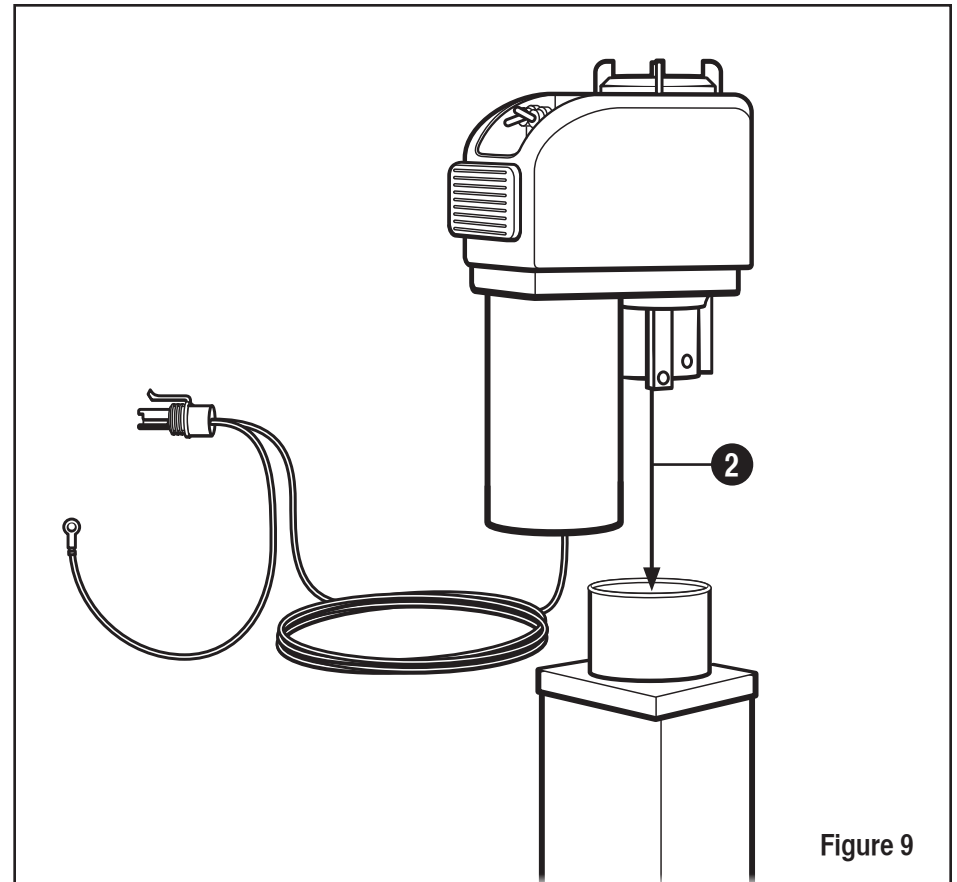

Figure 9

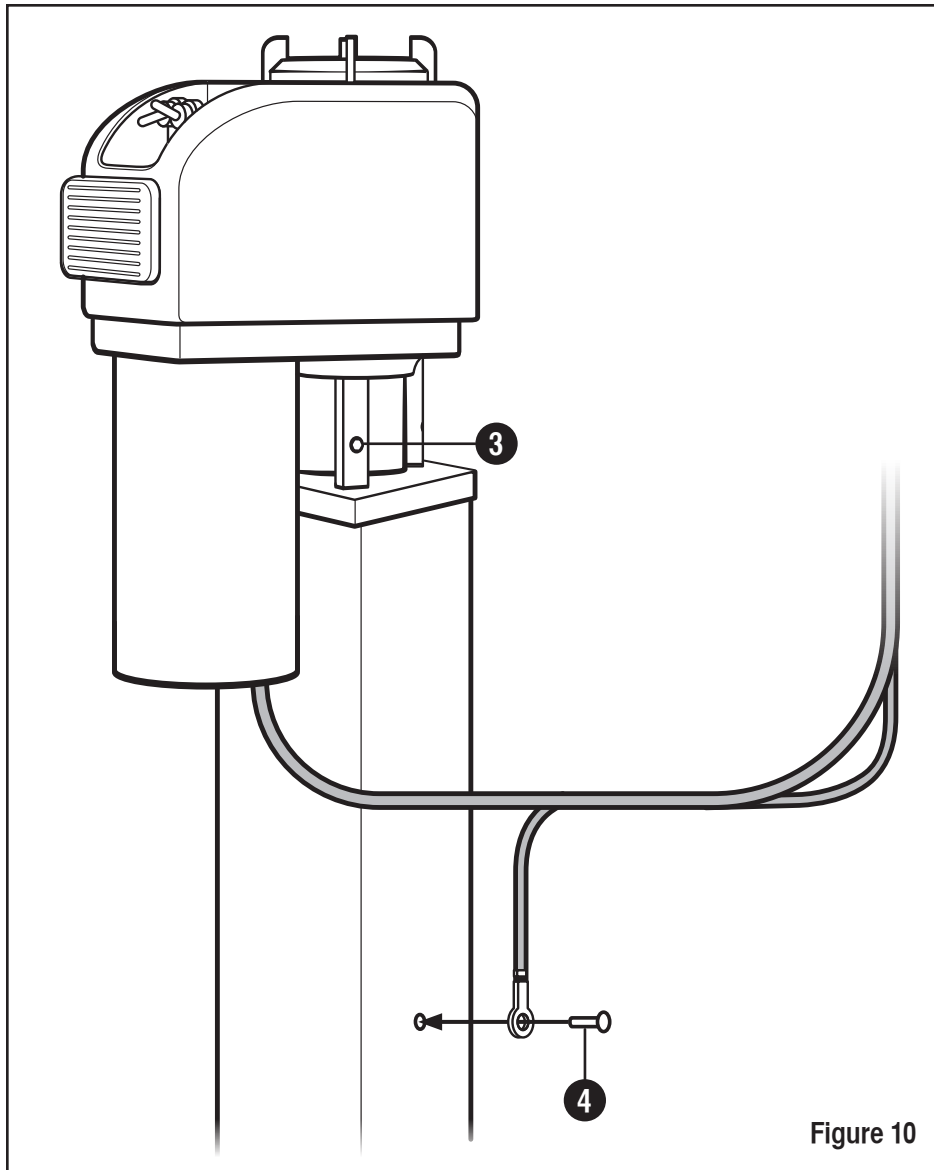

Figure 10

Connecting the Wiring

Important! Failure to have a fuse between the battery and Powerhead may result in damage to the Powerhead. You **must** have a 30 amp inline fuse between the battery and the Powerhead or damage to the Powerhead will not be covered under the warranty.

1. Run 10 gage wire directly from the battery, through a 30 amp inline fuse, to the quick disconnect at the rear of the vehicle (**Figure 11**).
2. Secure the ground (black) wire to the frame of the vehicle near the Swing Away hitch.
3. Connect the quick disconnect from the Powerhead to the quick disconnect of the top Swing Away arm.
4. Connect the quick disconnect of the lower Swing Away arm to the quick disconnect at the rear of the vehicle.

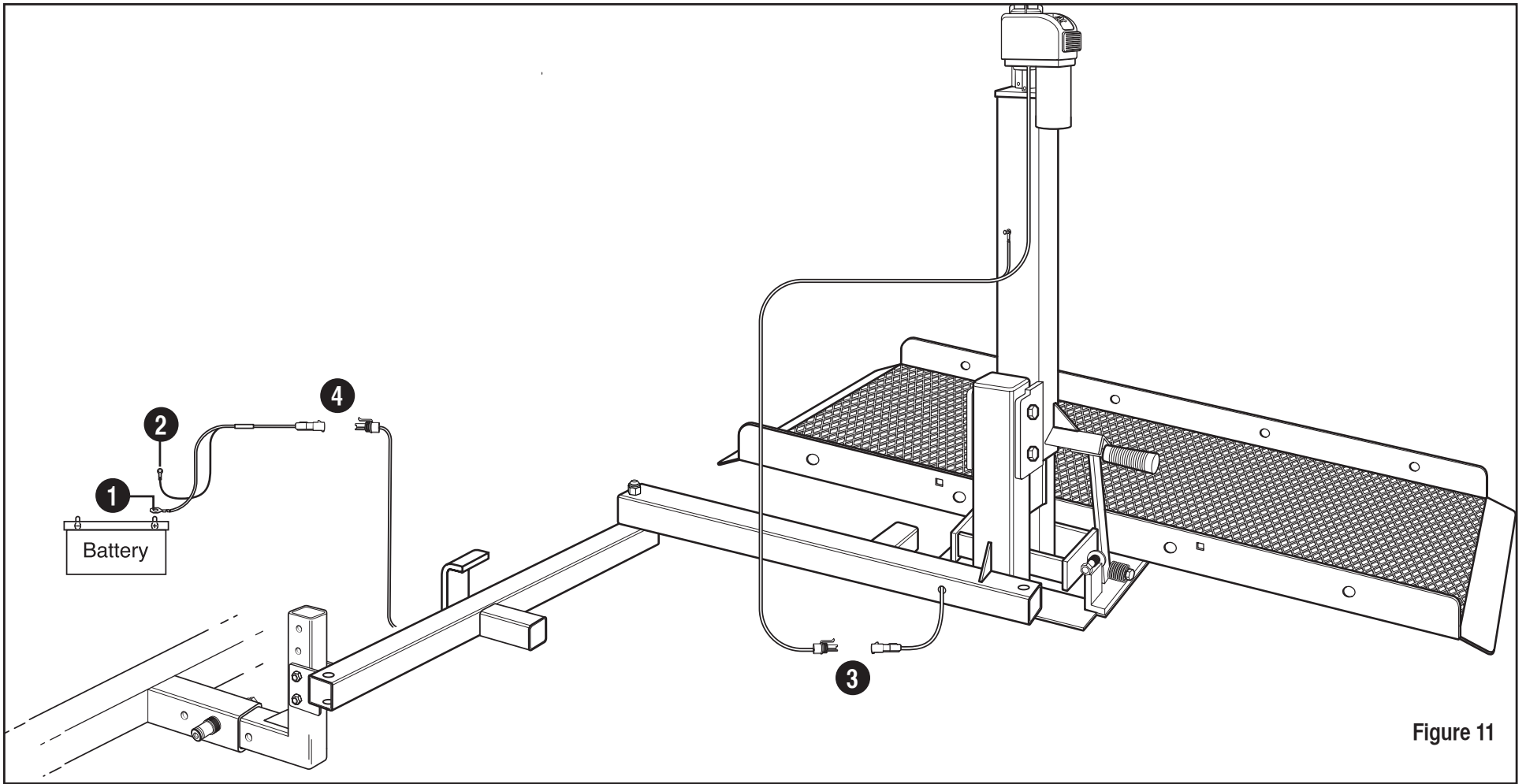
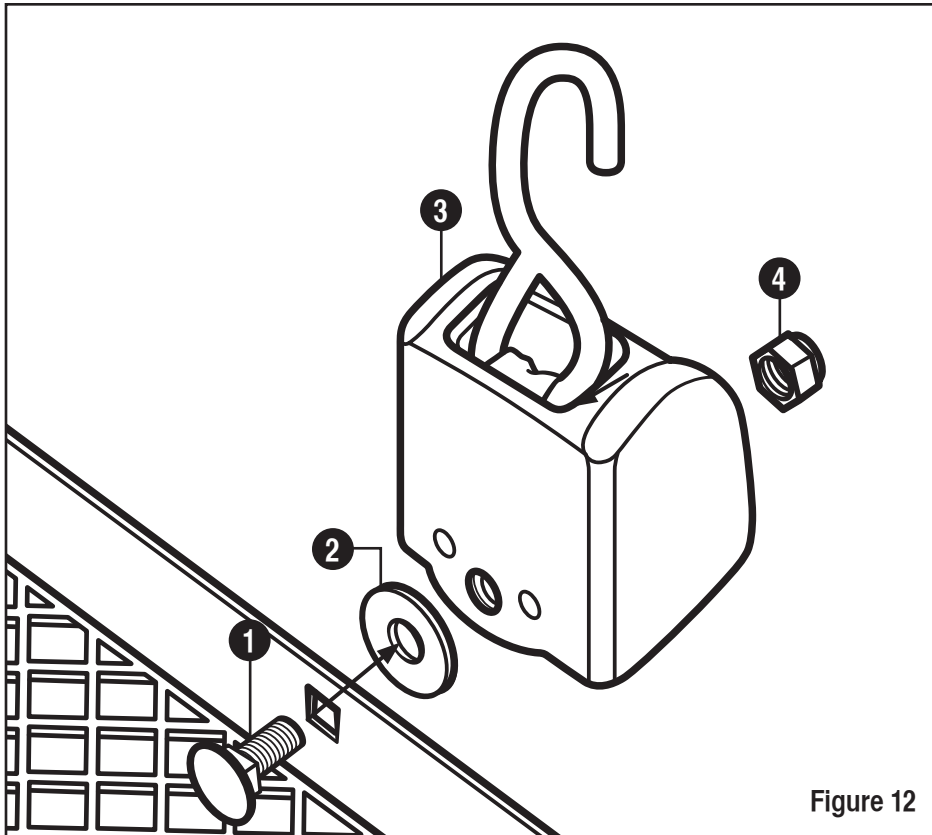

Figure 11

Attaching the Cargo Buckle

1. Insert the carriage bolt into the square hole (**Figure 12**).
2. Place the 5/8" washer over the carriage bolt.
3. Place the carriage bolt through the cargo buckle.
4. Place the nut on the screw and firmly tighten.
5. Check that the cargo buckle is securely attached.



Operation

Raising and Lowering the Platform into the Storage Position

Important! The Lift Arm will release from the “V” bracket when the platform is lowered. NEVER insert the Lift arm in the “V” bracket while the cargo is loaded on the lift.

1. Raise, or lower, the Lift until you are able to place the Lift Arm into the “V” bracket (**Figure 13**).
2. With the Lift Arm set in the “V” bracket, use the toggle switch and raise the platform up until the platform is in the storage position (**Figure 14**).
3. With the Lift Arm set in the “V” bracket, use the toggle switch and lower the platform until the platform rests evenly on the ground

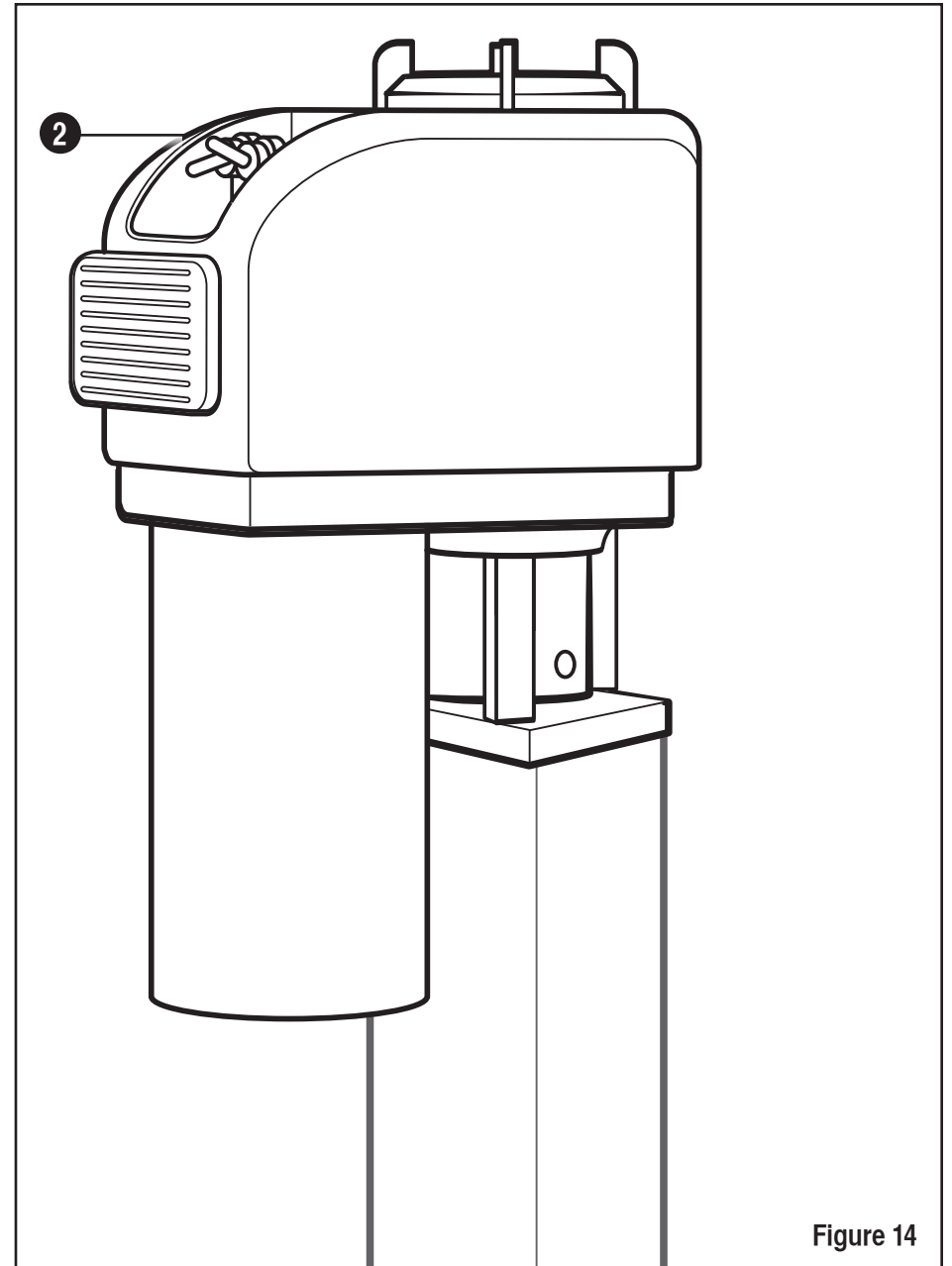
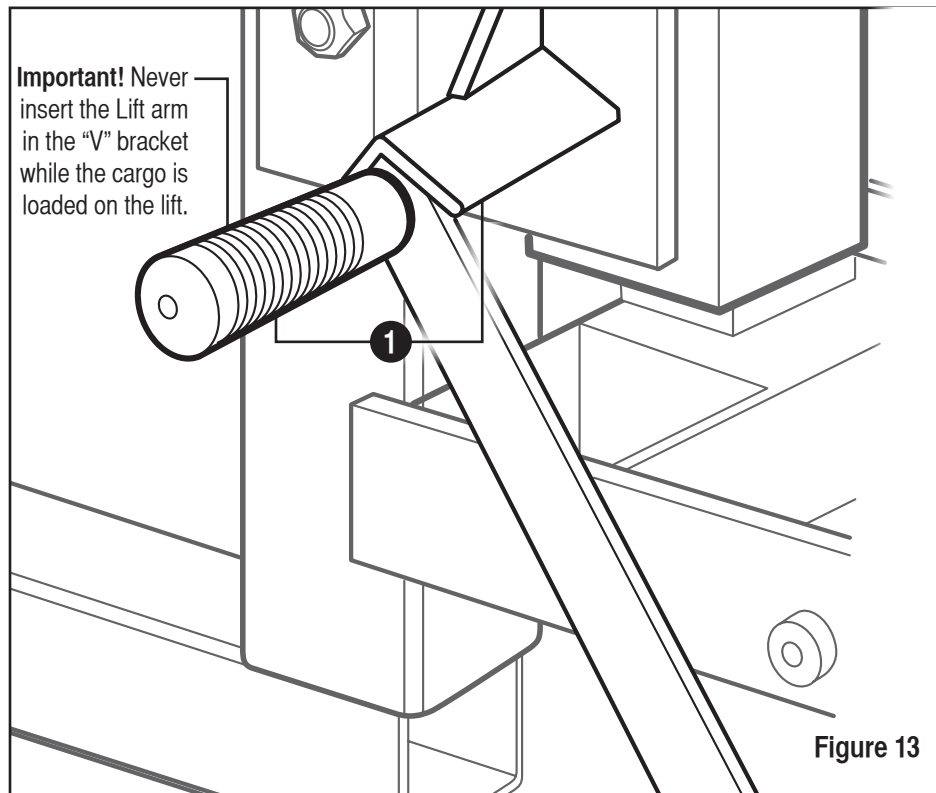

Raising and Lowering the Platform

1. The lift may be moved up or down using the left toggle switch on the Powerhead (**Figure 15**).

Note: When the Powerhead reaches the end of its travel (18 or 24 inches) a built in torque limiter goes into operation and you will hear a clicking sound. The torque limiter permits the final gear to slip, and thus, protects the unit. Prolonged operation of the torque limiter is not recommended.

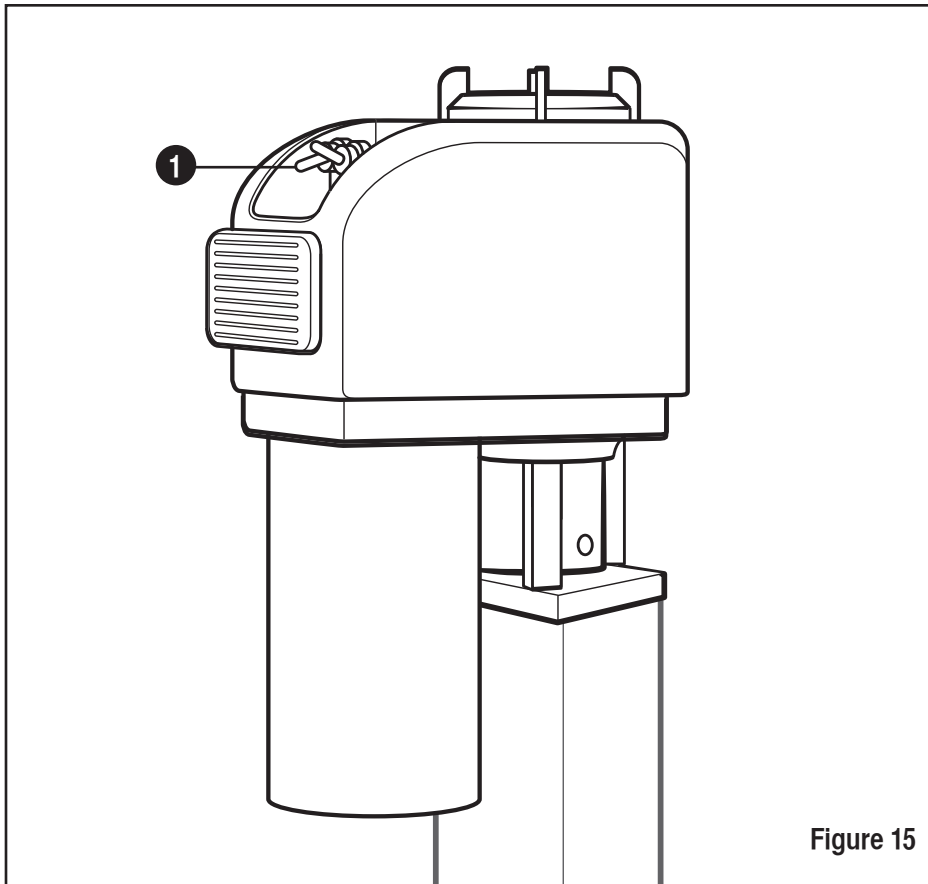

Figure 15

In an emergency situation when power is lost to the Powerhead you can manually raise and lower the platform using the following steps:

2. Unplug the power at the Swing Away hitch or optional Swing Away Attachment (**Figure 16**).
3. If the Powerhead is attached to the lift, open the cover. Insert the square head end of the Crank Handle onto the post inside the Powerhead (Note: If the Crank Handle is not available a 3/8 drive extension can be used). Turn counter-clockwise to raise the platform up. Turn clockwise to lower the platform.
4. If the Powerhead is removed from the Lift, insert the pin end of the Crank Handle into the Lift post. Turn counter-clockwise to raise the platform up. Turn clockwise to lower the platform.

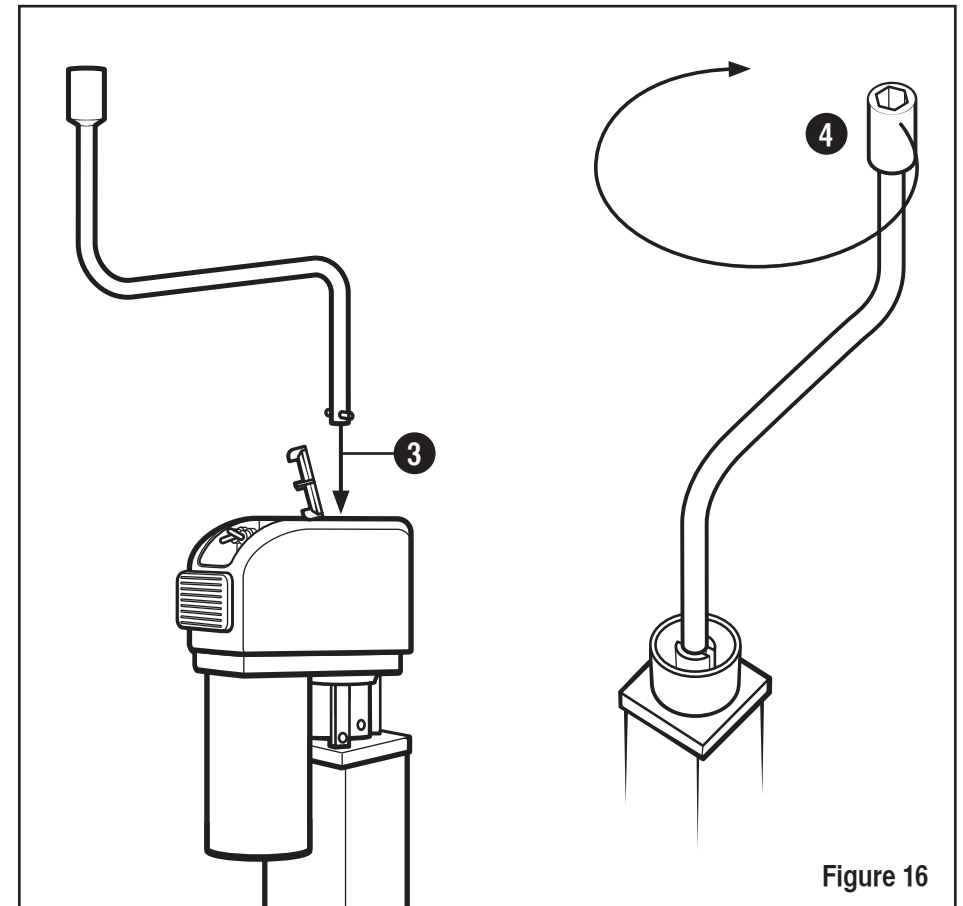
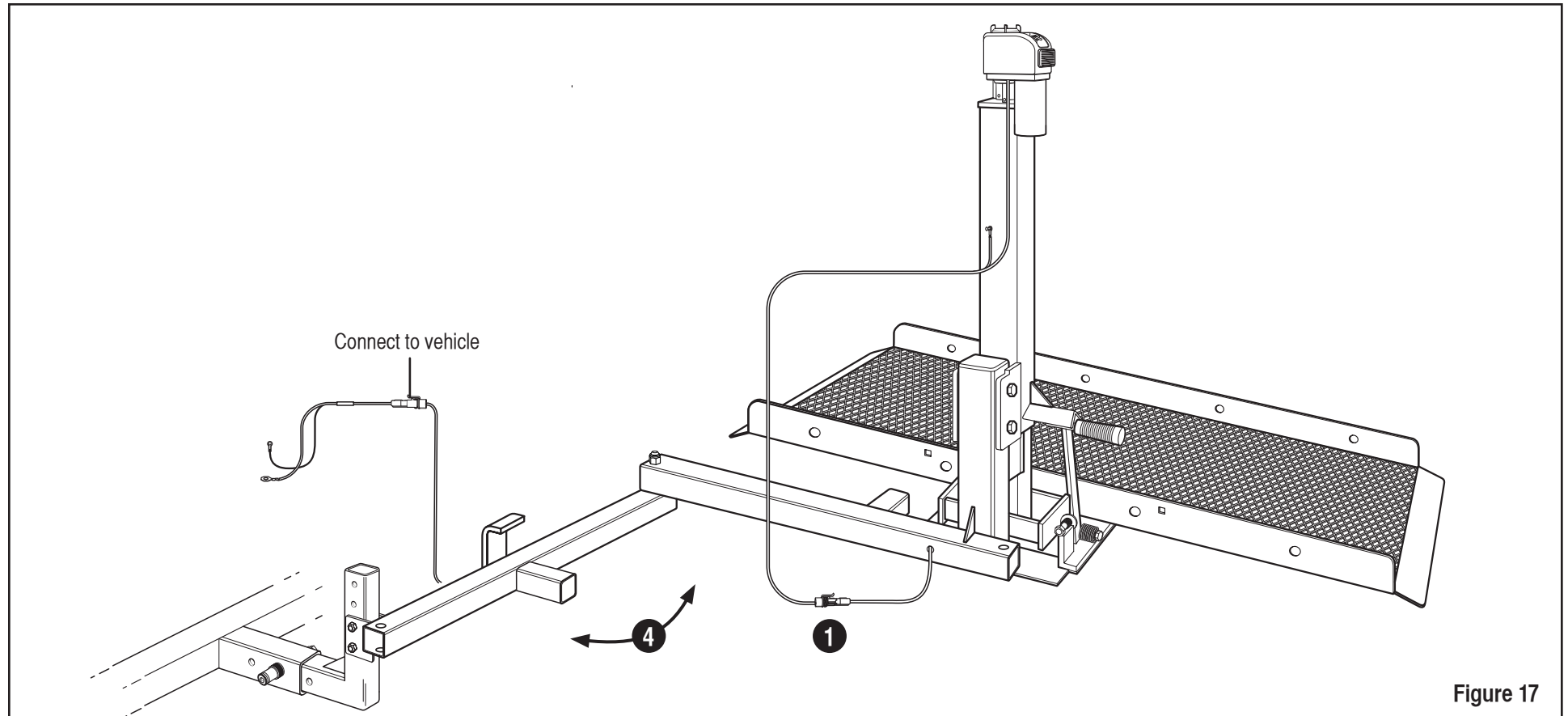
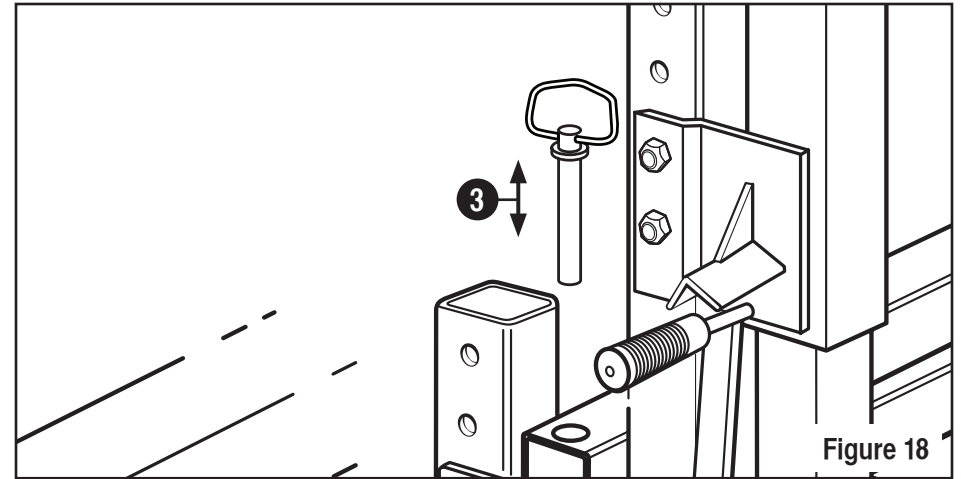

Figure 16

Operating the Swing-Away Attachment

Important! Always check that the swing-away attachment is in the closed position and cannot move when driving the vehicle.

1. Check the quick disconnect from the Powerhead is connected to the quick disconnect in the arm (**Figure 17**).
2. Remove the Keeper from the Hitch Pin.
3. Remove the Hitch Pin to open the Swing Away (**Figure 18**).
4. Manually move the swing-away attachment out.
5. After completing your task move the swing-away attachment back into the closed position and insert the Hitch Pin and the Keeper.
6. Pull on the Hitch pin to ensure the swing-away attachment is securely locked.



Return and Cancellation Policies

Return Policy

In an effort to keep our prices as low as possible, we do not build extra fees for returns into our prices. We are happy to accommodate customers who wish to return a product, however we must recover the costs we have incurred as a result. Please read our policy in its entirety before you purchase a carrier so that there is a mutual understanding when you make your purchase. Thank you!

When your new product arrives you have 10 days to inspect it for any defects or damage. If there are any defects or damage, the manufacturer will repair it at no cost to you, or replace it at the manufacturer's option. The item to be returned must be in new condition, with original packaging, instructions, and warranty material.

If the product is delivered and there are no defects in materials or workmanship, but you do not like it for any reason, you have 10 days following delivery to return it. Simply call our customer service number at 888-302-2774 and let us know what it is you want to return. We will send you a Return Authorization Release Form. Upon the return of your signed form we will issue a Return Authorization Number.

You the customer are responsible for packaging and shipping the product to us. If you do not have the original box one may be purchased from us, at the cost of the box plus shipping. Once received at the manufacturer's facility in like new condition, we will refund your purchase price of the product, less a 20% restocking fee and the original outbound freight charges. If original shipping fees cannot be established, we will use our current shipping rates.

Cancellation Policy

Our products are normally in stock and we try to ship the same day we receive your order. If you need to cancel an order for any reason, please notify us as soon as possible. If we have not shipped your order, there is no fee for cancellation, but if your order has already shipped, our return policy, as stated above, is in effect. This is due to the fact that the item must be re-packaged once the shipper has returned it to us, and we incur shipping charges outbound and inbound for shipping either way.

Limited Warranty

This product is warranted to be free from any defect in materials used in the manufacture, and/or workmanship at the time of its manufacture. The manufacturer's warranty period is one year unless otherwise specified at time of sale. Any part found to be defective during this period will be repaired or replaced at the discretion of EZ Carrier, LLC. Any part replaced under the warranty will be covered for the remaining period of the warranty. Any parts replaced under the warranty must be returned to EZ Carrier, LLC and will become the property of EZ Carrier, LLC. EZ Carrier, LLC may, at its discretion make any repairs or replacement of defective parts but such work shall not be deemed to be any admission of liability. EZ Carrier will bear labor charges for work carried out under the warranty. The warranty may not be transferred to subsequent owners for the balance of the remaining warranty period.

Conditions and Exclusions:

- The product must not have been used for competition, misused, inadequately maintained, or incorrectly serviced or maintained.
- The product must not have been subject to any modification, repair, or replacement other than as authorized by EZ Carrier, LLC.
- Defects caused by faulty adjustment, neglect, or repairs and alterations performed by anyone other than EZ Carrier, LLC are not covered by this warranty.
- Defects caused by the use of parts and accessories not authorized by EZ Carrier, LLC are not covered by this warranty.
- The warranty does not cover the cost of transportation of the product to or from EZ Carrier, LLC, or expenses incurred while the product is out of use and under warranty repairs.
- The warranty does not cover product used on a commercial basis.
- The warranty does not cover defects, which have not been reported to EZ Carrier, LLC within the immediate discovery of the defect.
- Should a warranty claim become necessary, EZ Carrier, LLC shall not be liable for loss of use, inconvenience, lost time, commercial losses or other incidental or consequential damages.
- If for any reason, the carrier does not appear to be in good and sound condition, it must not be used. Any loss as a direct or indirect result of the use of the carrier in a compromised condition is the sole liability of the user.
- Paint finish will diminish, scratch, and chip over a period of time due to normal use and therefore paint is not covered under warranty, nor is rust that has resulted from exposed surfaces.
- Actuator and motor on the lifts carry no warranty other than that of the manufacturer of them; actuators, 90 days; motors, one year (EZ Carrier LLC does not make these specific parts).
- Must present copy of this paper work along with copy of proof of purchase as in copy of credit card statement or such. at time of warranty work.
- Any statement, condition, representation, description or warranty otherwise contained in any other publication or advertisement shall not be construed as enlarging, varying or overriding anything contained herein.
- EZ Carrier, LLC reserves the right to make alterations or improvements without notification to any model without obligation to do so to products already sold.

Liability Disclaimer:

The purchaser of the carrier is solely responsible for the installation, use, and the securing of any item being carried. In no event shall EZ Carrier, LLC be liable for any damages whatsoever, including but not limited to any direct, indirect, special, consequential, punitive or incidental damages, or damages for loss of use, profit, or other intangibles, or the cost of procurement of substitute goods and services, arising out of or related to the use, inability to use, unauthorized use, performance or nonperformance of our products. Even if EZ Carrier, LLC has been advised previously of the possibility of such damages and whether such damages arise in contract, negligence, tort, under statute, in equity, at law or otherwise. In no circumstance shall EZ Carrier be liable for any losses or damages whatsoever. All matters are interpreted under Oklahoma law.